

MODEL L-27 DIAGRAM

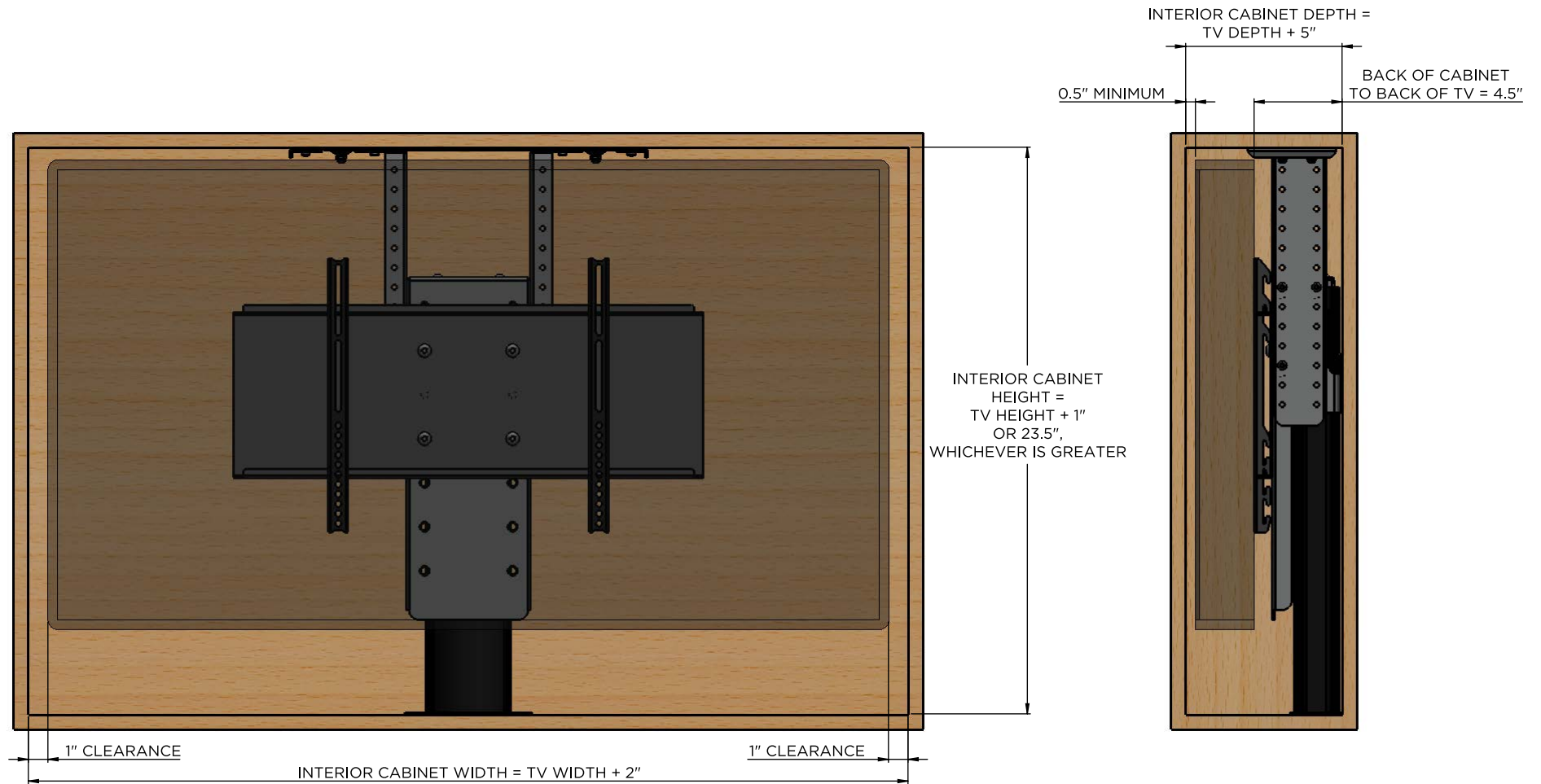

NOTES:

1. THE CABINET BOX SHOWN IN THE DIAGRAM IS FOR REFERENCE ONLY AND IS NOT PROVIDED WITH THE LIFT SYSTEM
2. FOR THIS LIFT MODEL, THE LENGTH OF ITS TRAVEL [EXTENSION LENGTH OR STROKE] IS 26.5"
3. FOR THIS LIFT MODEL, THE TOTAL WEIGHT CAPACITY IS 130 LBS
4. HEIGHT OF THIS MODEL IS ADJUSTABLE IN 1/2" INCREMENTS UP TO 8" [MINIMUM HEIGHT = 22.5"; MAXIMUM HEIGHT = 30.5"]
5. LID IS DESIGNED TO FLOAT WITH PROVIDED TAPERED PINS - LID MUST BE REMOVEABLE FOR SAFETY
6. WHEN DETERMINING TV HEIGHT, ALWAYS USE MANUFACTURER SUPPLIED "TV WITHOUT STAND" HEIGHT
7. LIFT MECHANISM IS POWDERCOATED BLACK STEEL - COLORS IN DIAGRAM ARE FOR CLARITY ONLY

nexus²¹
CONCEALMENT SYSTEMS

COPYRIGHT 2016 - ALL RIGHTS RESERVED
UPDATED 01/13/16